

APPLICATION

Various types of KWT flapvalves are available for use in surface, sewer and process water systems. The flapvalve has been used for many years, however the KWT range now uses more modern materials to improve reliability, and durability, whilst keeping maintenance requirements to a minimum.

Various mounting methods are available to suit a number of applications, and they can also be easily modified for special requirements.

OPERATION

The KWT flapvalves consist of a plate, hinged at the top, connected to a mounting frame. Water discharging from the pipe opens the flap, however when the head increases on the downstream side, the flap is pressed against its seal, preventing backflow.

Even though these larger flapvalves are very robust, they still only require a small head in the pipe to open the flap, as HDPE floats in water- the flapvalves are fitted with a counterweight to balance the flap correctly.

The KRK 600-1500 range is similar in concept to the smaller types, however additional features, including welded stiffening ribs, are used due to the heavier duty applications required. The 600-1500 range still maintain the benefits of the smaller types, such as low maintenance, relative low weight and ease of installation.

The flapvalves are available with a number of mounting arrangements, and we pride ourselves on our ability to produce bespoke flapvalves and pumpvalves where something special is required.



Supplied by
ACE AQUATIC
CONTROL
ENGINEERING LTD
HALL FARM, MAIN STREET, RAMPTON, NOTTS,
DN22 0HR.
PHONE 01777 249080, FAX 01777 249069
WWW.AQUATICCONTROL.CO.UK
EMAIL: INFO@AQUATICCONTROL.CO.UK



SPECIFICATIONS

Sizes:	Ø 600 mm to Ø 1500 mm
Operating pressure:	Maximum 5 MwC Short term
Valve cover angle:	15° as standard except for flat-wall mounted models
Higher pressures and larger dimensions on request.	
Various connection options such as: PVC/HDPE tube, flange, wall, under an angle, concrete/SPIROsol.	

MATERIALS

Valve plate:	HDPE
Back plate:	HDPE
Shaft and ballast weight:	SS316
Seal:	EPDM seal

BENEFITS

- Easy to install- no grouting required
- Relatively light in weight because HDPE is used.
- Virtually maintenance free.
- UV & Impact Resistant
- Standard sizes available from stock for quick dispatch

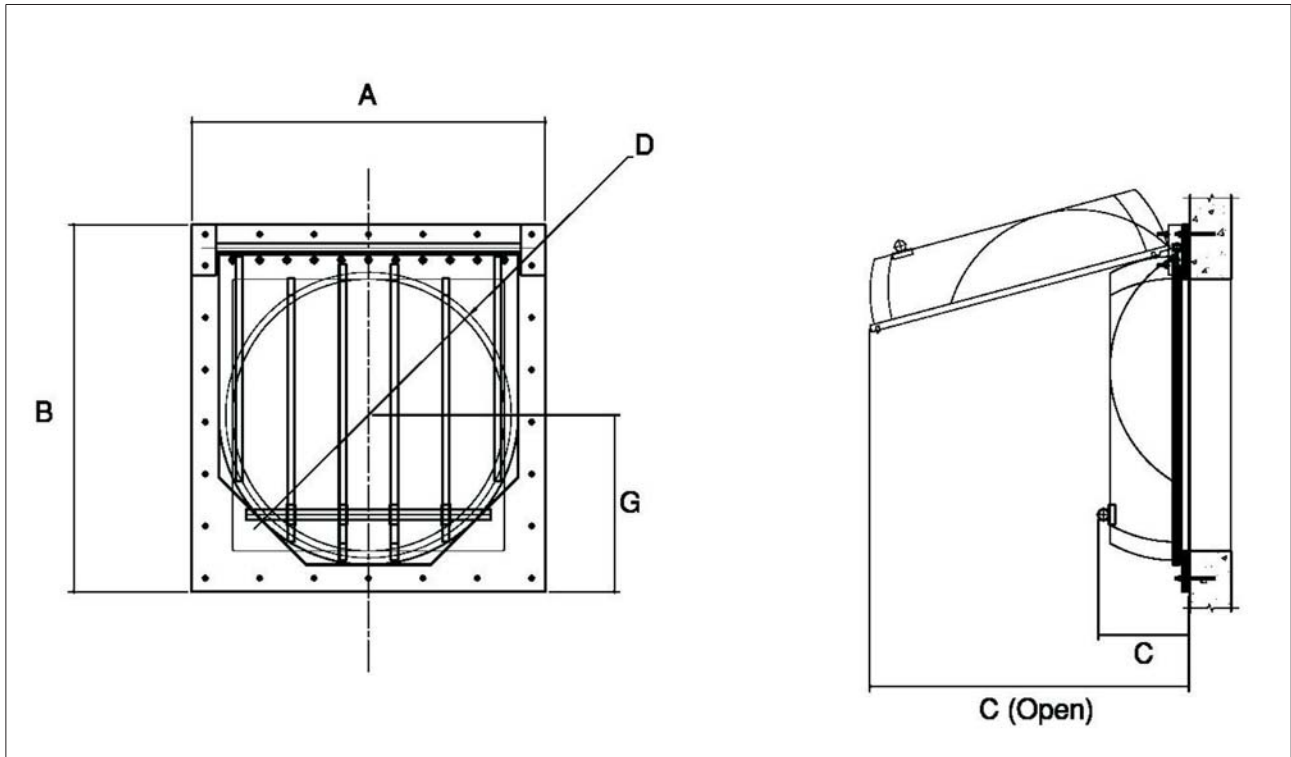

NW mm	D mm	A mm	B mm	C mm	C (Open) mm	G mm
600	600	900	950	215	790	450
700	700	1000	1050	240	885	500
800	800	1100	1150	265	980	550
900	900	1200	1250	290	1080	600
1000	1000	1300	1350	325	1175	650
1200	1200	1500	1550	375	1370	750
1500	1500	1800	1900	460	1845	900

Product Overview

Flap valve, KLK 100-500 type

Manufactured by: KWT Waterbeheersing
Materials: HDPE, SS316, EPDM
Standard passage: Ø 600 mm to Ø 1500 mm
Working pressure: Maximum 5 MwC

The valve plate and the back plate are produced using HDPE. The hinge pin and ballast weight are produced in SS316 as standard. The ballast weight can be easily adjusted if required. The sealing arrangement consists of an EPDM lip seal in the back plate. The valve plate is also installed on an angle in relation to the back plate to ensure a good seal.

